

# COMEUP WINCH

Getting you through since 1975



## SEAL SERIES

---

## INSTRUCTION GUIDE



To prevent any serious injury, do not install or operate this winch before reading this manual. Keep this manual with the winch at all times. Winch operators must read and understand contents fully. Know the specific function of your winch.

### 1. On/Off Switch :

Your Seal 16.5rs/16.5rsi/20.0rs winch has an on/off switch; it is to power on to activate or deactivate the wireless remote control of the winch.

The on/off switch could also cut out the battery draw of wireless remote control module when the engine is not running.



### 2. Vehicle Battery Voltage Reading :

Once the battery is lower than 8V, the warning alarm will start beeping.

### 3. Over-heat Protection :

There are two kinds of over-heat protection warnings to protect the motor and control from being damaged or personal injury :

- a. Handheld remote warning: The two green LED indicators on the wired remote control will turn red if the motor is over-heating.
- b. Buzzer warning: When motor is over-heating, the Seal winch will induce a buzzer alarm.

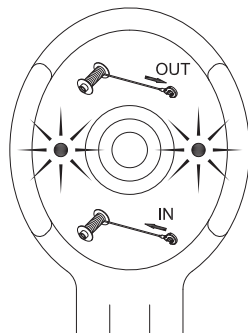

Handheld Remote Warning



Buzzer warning

### 4. Wireless Transmitter Signal :

The LED indicators on the wireless transmitter indicate the signal condition. If green, the signal is good; red is weak.

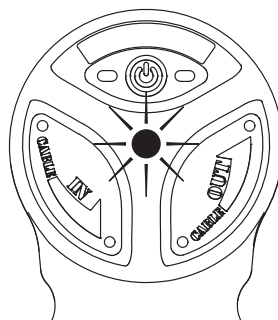

Wireless Transmitter

5. Handheld wired remote control :

All automotive winches are supplied with a wired remote control to activate and operate the winch. Two green LEDs indicator of wired control will be illuminated after the remote plug in the socket of control box.

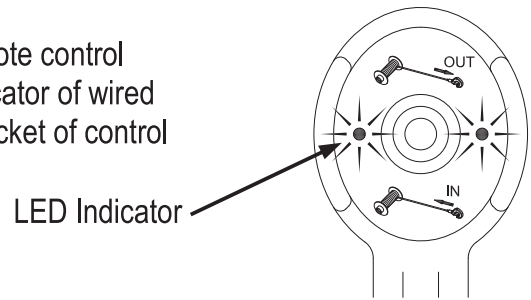

6. Wireless Transmitter :

Your winch comes with a wireless transmitter. Press and hold the power button for 5 seconds to activate winch operation. The green LED Indicator lights up. Regarding wireless remote pairing, Please check the winch wireless remote instruction manual.

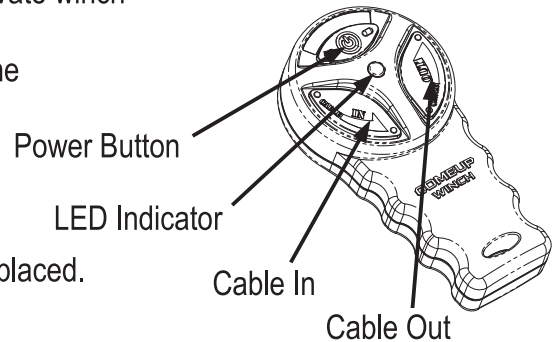

7. Wireless transmitter's battery life :

If green LED indicator on the wireless transmitter is flashing, the battery of the transmitter need to be replaced.

► Wireless Receiver & Transmitter



This wireless remote control device complies with CE mark, FCC and Industry Canada (IC) rules. There are two control modules of Seal series winches. All are similar in setup, but with differing responses in regards to their control type.

- 1). Seal 16.5rs/16.5rsi /20.0rs:
  - a. With both wireless and wire remote control.
  - b. After on/off switch is powered on, the buzzer warning until the remote control is tuned.
  - c. Overheating buzzer warning.
- 2). Seal 16.5/16.5s/20.0/20.0s :
  - a. With wired remote control.
  - b. Overheating buzzer warning.

► Seal 16.5rs/16.5rsi/20.0rs with on/off switch and buzzer warning.

1). **Wireless remote control module :**

Applicable models		Seal 16.5rs/16.5rsi/20.0rs		
LED & Buzzer				
		Buzzer	Transmitter LED	Remote Control LED
Turn on		2 short beeps for 10 seconds	X	Green
Press Transmitter for 5 seconds		X	Turn on Green	Green

Pairing	Long beeps for 5 seconds	Turn on Green	Green
If pairing failed, please check the winch wireless remote pairing Instruction manual.			
Wireless control in operation	X	Red	Green
Wireless control not in operation	X	Green	Green
Motor over-heat warning	2 short Beeps every 5 seconds	Green	Red
Low voltage on transmitter	X	Green	Green
Poor signal warning	X	Red	Green
Press the power button for 5 seconds to turn transmitter off.	X	X	Green
Press the power button to turn winch off.		X	Green

Remarks: While using wired control, it is not necessary to power on on/off switch

**2).Wired remote control (2 LEDs on remote control),For Seal 16.5/16.5s/20.0/20.0s only :**

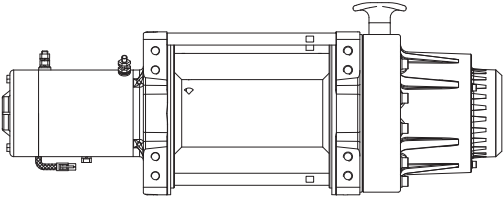
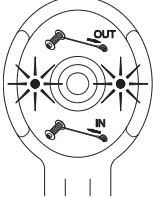
Applicable models	Seal 16.5/16.5s/20.0/20.0s	
LED & Buzzer		
	Buzzer	Remote Control LED
Plug in connector	X	Green
Cable in/out operation	X	Green
Motor over-heat warning	X	Red
Plug out connector	X	X

### ► Replace of a battery on the Wireless transmitter

When the green LED Indicator is flashing indicates an extreme low battery level of wireless transmitter. The battery should be replaced.

1. Turn cover counterclockwise to open.
2. Replace new battery and put the cover back.
3. Turn cover clockwise to close.

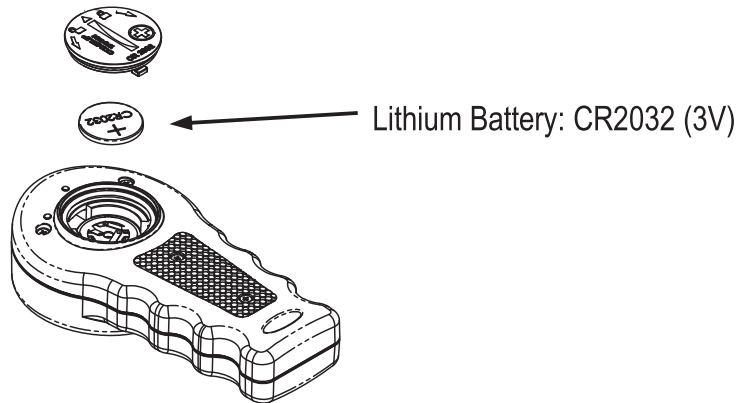

### ► Battery Recommendations and lead size

A fully charged battery and good connections are essential for the proper operation of your winch. The minimum requirement for battery is 650 cold cranking amps. The voltage drop for the winch motor must not exceed 10% of the nominal voltage of 12/24V DC.

The battery lead shall be 2 gauge with 1.83 m in length at most, otherwise a considerable voltage drop will be happened.

### ► Wiring Diagram

Attach the black lead firmly to the negative (-) battery terminal and red lead to the positive (+) battery terminal. The voltage drop for the winch motor must not exceed 10% of the nominal voltage of 12/24V DC.

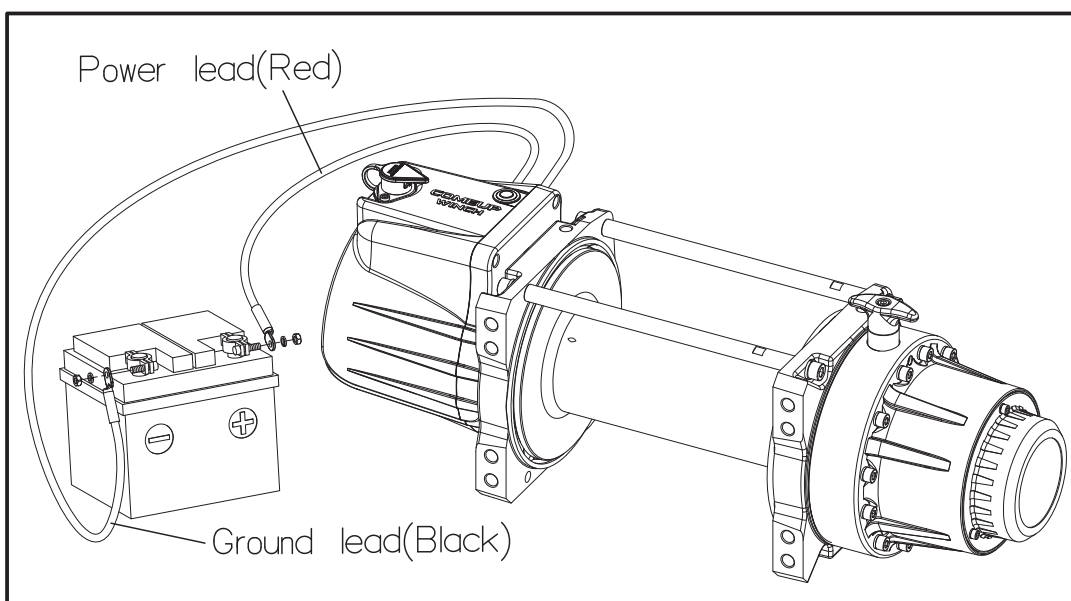

► **Cable-in/Cable-out Operation**

1. Wired Remote Control :

- 1.1 To" winch or cable - out", trigger → out.
- 1.2 To" winch or cable - in", trigger ← in.
- 1.3 To stop winching, release the trigger.

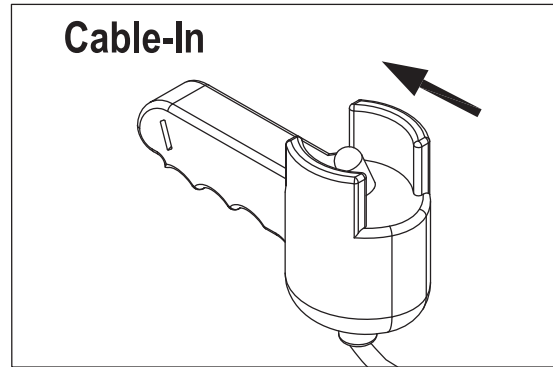
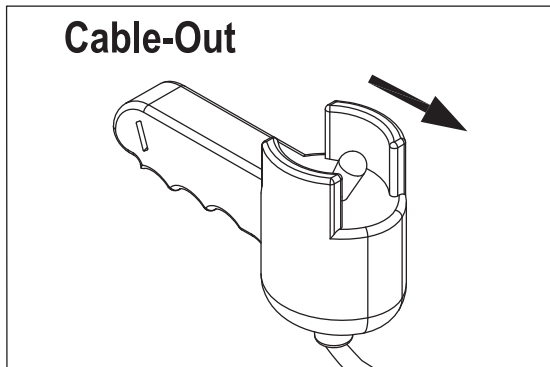

2. Wireless Remote Control :

- 2.1. Press and hold the Cable in button of the transmitter for rope winding in operation.
- 2.2. Press and hold the Cable out button of the transmitter for rope winding out operation.
- 2.3. Stop winching, release the cable in or cable out buttons.

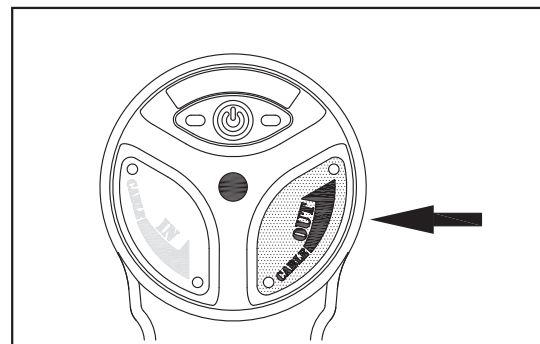
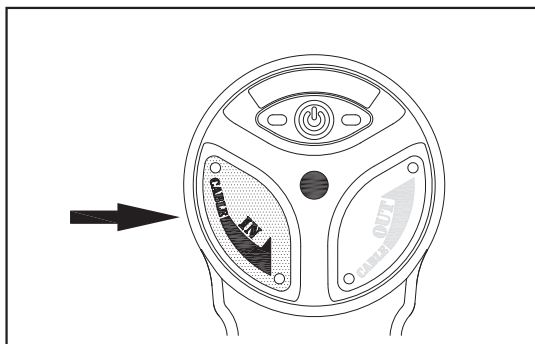

3. Wireless Remote Control as an Additional Emergency Stop Function:

Both press the power button and Cable-in or Cable-out button also works as an emergency stop if the wireless remote control is in malfunctions for any reason. While the wireless remote control is in operation (either winch in or winch out, the red light is on), once the power button and Cable-in or Cable-out button are pressed, the wireless remote control is forced to power off immediately. Winch will stop running accordingly.

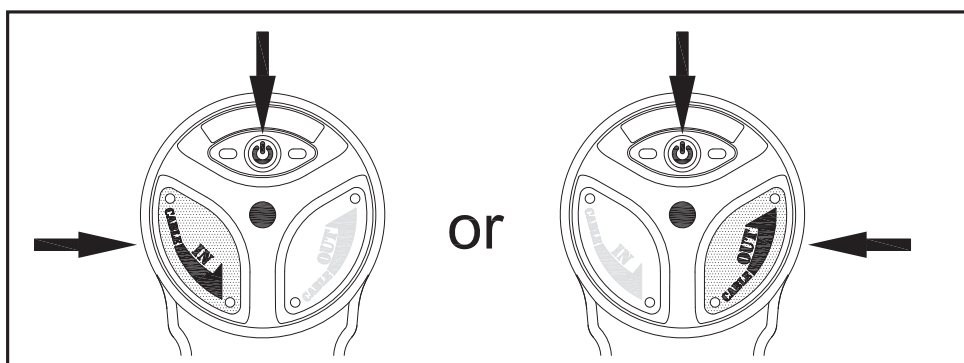

► **Shut Down the Winch Permanently**

Power off the On/Off switch directly.

► **Clutch Function**

1. The clutch allows rapid pay-out of the wire/synthetic rope for hooking onto a load or anchor points and is operated by a clutch T-handle.
2. The clutch T-handle must be in the “Engaged” position before winching.
3. To disengage, Lift the clutch T-handle up and turn it counter-clockwise to the “Disengaged” position. Wire / synthetic rope can now free spool off the drum.
4. To engage, Lift the clutch T-handle up and turn it clockwise to the “Engaged” position.
5. If a clutch T-handle can’t be properly locked in the “Engaged” position, rotate the drum to help the clutch device engage the gear train.
6. Wear gloves and use a hand saver strap when guiding the wire/synthetic rope off the drum.
7. Never disengage the clutch while wire/synthetic rope is under load.

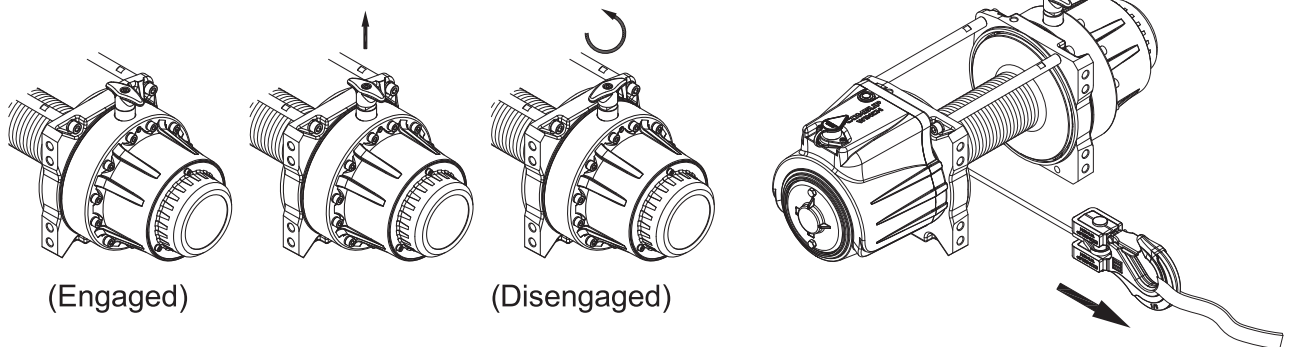

► **Replace T type clutch kit**

1. Loosen the socket set screw securing the clutch T-handle threads in the gear housing.
2. Remove the T-handle from the gear housing.
3. Thread the new clutch assembly completely into the gear housing.
4. Tighten the socket set screw securing the clutch mechanism threads into the gear housing.
5. Reinstall the secure cap screws are tighten.

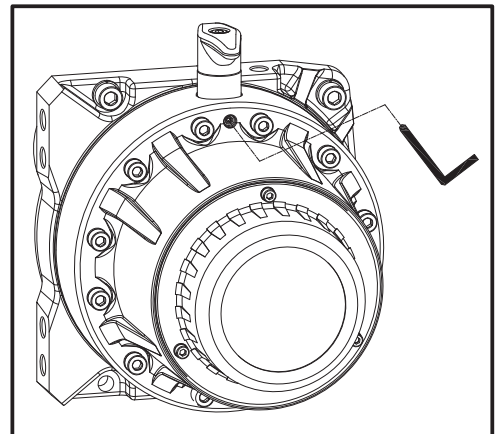

► **Clutch Repositioning**

Change the position of the Free-Spool T-handle according to the following steps.

1. Loosen and release the bolts on the brake rear cover for separating the brake rear cover away.
2. Loosen and release the bolts on the gearbox away for separating the gearbox away.
3. Rotate the gearbox by a proper angle increments mentioned on the below chart to the required position.
4. Re-assembly the gearbox and rear brake cover.



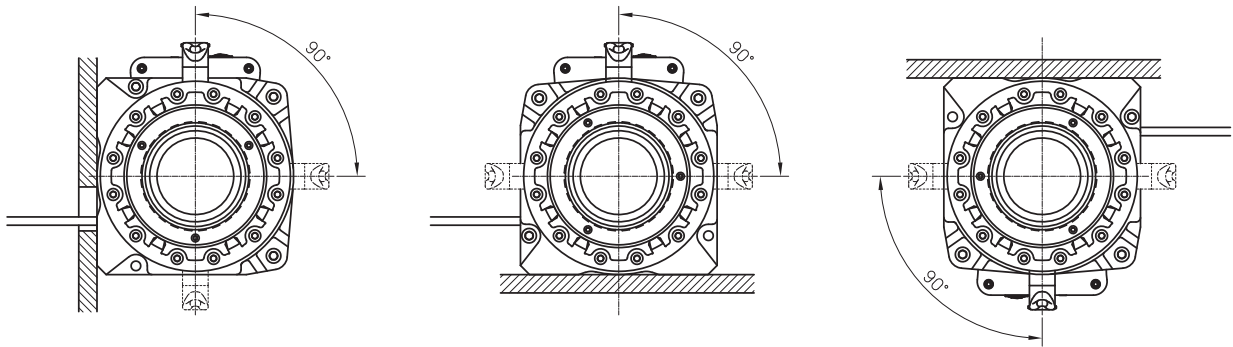

► **Mounting Configurations**

The payout direction for wire/synthetic rope or the correct methods for mounting the winch vary according to different winch model. Do wind the rope from the bottom of the drum. At any condition, do not position the load direction away from the mounting base plate.

Winch Model	Mounting Position		Repositioning	
	Foot Down	Foot Forward	Clutch Angle	Motor Angle
Seal 16.5/16.5s/16.5rs/ 20.0/20.0s/20.0rs	-	V	90°	90°
Seal 16.5rsi	-	V	90°	-

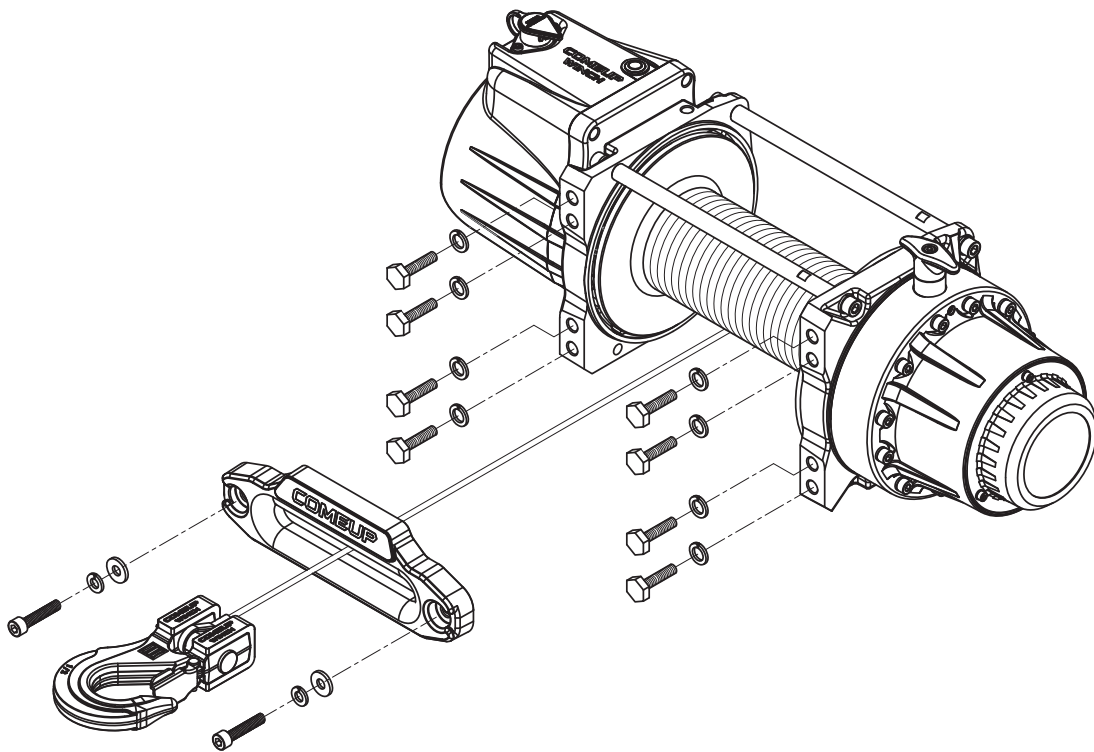

### Limited Lifetime Warranty for Mechanical Components Limited Three(3) Year Warranty for Electrical Components

#### Seal Series WARRANTY

Comeup Industries Inc. (COMEUP) warrants to the original purchaser that the mechanical components of the COMEUP Automotive Winch will be free of defects in material and workmanship for the lifetime of the winch and the electrical components will be free of defects in material and workmanship for a period of three (3) years for Seal winch from the original date of purchase. All COMEUP mounting kits and other accessories carry a one (1) year limited warranty against defects in material workmanship.

This warranty applies only to the original purchaser of the winch. To obtain any warranty service, the purchaser under this Limited Warranty is requested to advise COMEUP or its authorized distributors on any claim. The purchaser must provide a copy of the purchase receipt bearing the winch serial number, date of purchase, owners name, email or Tel & Fax, address and purchaser vehicle details. Any products that COMEUP determines to be accountable for defective will be repaired or replaced or refund at COMEUP sole discretion without charge to buyer upon buyer's compliance with these procedures. In the event of repair or replace, purchaser must send the defective winch or part, with freight prepaid, to COMEUP or its authorized distributor. And COMEUP will send the serviced product back to purchaser on COMEUP's cost. This warranty does not cover the removal or reinstallation of the winch.

COMEUP takes the responsibility for COMEUP winch parts and components to be free from defects in materials and workmanship, but the following portions are hereby excluded and disclaimed. COMEUP or its authorized distributors may make reasonable charges for parts and labour for repairs or resumption in the following portions not covered by this limited warranty.

- (1). All warranties of wire rope and synthetic rope assemblies after initial use
- (2). All warranties of fitness for a particular purpose
- (3). All warranties of the product's finish
- (4). All warranties of merchantability

The limited warranty does not cover any failure that results from improper installation/operation, third party part substitution, purchaser's alteration or modification on COMEUP winch. This warranty is void when COMEUP serial number plate is removed or defaced.

COMEUP's liability to the purchaser under the winch purchases for any loss or damage howsoever and whatsoever arising shall not exceed the price of the initial winch purchase receipt. COMEUP shall not in any event be liable to the purchaser for any consequential and/or indirect loss or damage whether for loss or for profit or otherwise, costs, expenses or other claims for consequential compensation whatsoever and whether caused by negligence of COMEUP employees, distributors and their employees or otherwise. COMEUP reserves the right to change product design without notice. In situations in which COMEUP has changed a product design, COMEUP shall have no obligation to upgrade or otherwise modify previously manufactured products.





















**COMEUP  
WINCH**

**COMEUP INDUSTRIES INC.**

No.139, Jieyukeng Rd., Ruifang Dist.,  
New Taipei City 22453, Taiwan

Tel: +886-2-24971788

Fax: +886-2-24971699

Email: [info@comeup.com.tw](mailto:info@comeup.com.tw)

[www.comeupwinch.com](http://www.comeupwinch.com)



PN 884377 Ver:00

Specifications subject to change without notice.